

**SIEGENIA** Innovations for you:

# AERO Vent duct EPP

## Your benefits<sup>3</sup>:

- ❶ Undisturbed view of the facade due to concealed installation
- ❷ Flexible adjustment to the building structure
- ❸ Increased sound absorption

## Clear appearance, clear benefits: Installation with EPP vent duct.

The new vent duct EPP ensures a clear, undisturbed facade view and simultaneously optimises the sound absorption. The freedom of design is also enhanced: Because a wide range of building situations can be achieved within the facade due to the vent duct. The vent duct can be combined with a wide range of wall-mounted ventilators, which meet the different room comfort demands, from the AEROVITAL ambience wall-mounted ventilator to the AEROPAC sound absorbing ventilator up to the versatile AEROTUBE in the versions DD, WRG smart and AZ smart.

The subject of flexibility was given great importance in the development of the new vent duct. For installation, it can be adapted conveniently to the building structure on site both in terms of its accurate positioning and its easy cropping. This also applies to the interior installation of the ventilator that can be accomplished either beside or at an incline above the window. In addition, the AERO EPP vent duct also scores in relation to aspects of sound absorption because it enables the achievement of extremely high sound absorption requirements up to 72 dB. The AERO EPP vent duct is suitable for new builds and renovations, in particular for thermal insulation composite systems (WDVS).

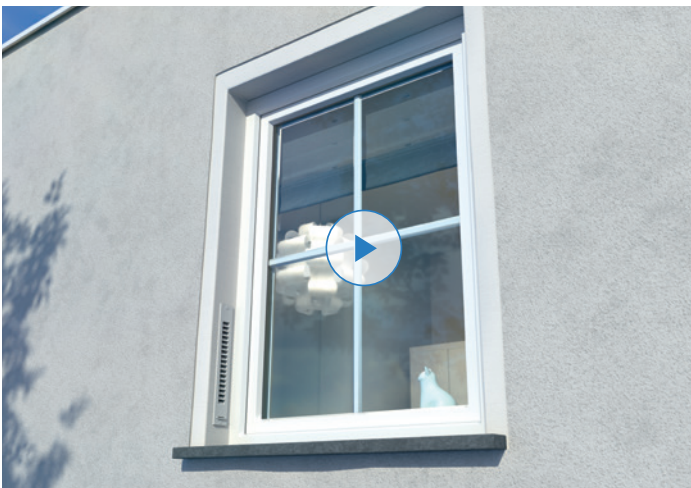

Practically invisible  
and easy  
to install.

### Benefits for fabricators

- Flexible adaptation to the building structure on site, easy installation
- Sound absorption pipe individually adaptable to wall thickness
- Easy plastering thanks to plaster cover to protect the duct
- Suitable for new buildings and renovations also for residential buildings and office buildings
- Architectural integration in an undisturbed view of the facade
- Suitable for wall-mounted ventilators AEROVITAL ambience, AEROPAC and AEROTUBE in versions DD, WRG smart and AZ smart
- High sound absorption (up to 72 dB)

### Benefits for end users

- Integration in the thermal insulation composite system
- Suitable for living rooms and bedrooms
- High sound absorption
- Undisturbed view of the facade

You can find more technical information on our website in the [Download portal](#).

Concealed installation thanks to vent duct.  
Watch the product film at:

[www.siegenia.com/en/product\\_film\\_vent\\_duct](http://www.siegenia.com/en/product_film_vent_duct)

## Discreet design due to vent duct EPP.

**AEROTUBE installation example: interior view**

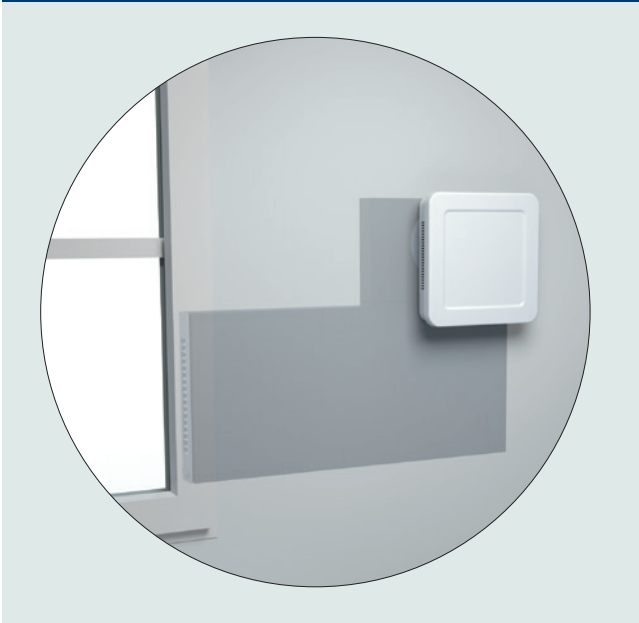

The vent duct can be used with different SIEGENIA-  
wall-mounted ventilators:

- AEROTUBE WRG, AZ smart and DD versions
- AEROPAC
- AEROVITAL ambience

**Facade view**



The new vent duct EPP ensures a clear, undisturbed  
facade view, installation is possible either laterally in the  
window reveal (SFL) or in the window reveal (FL).

**Vent duct SFL**

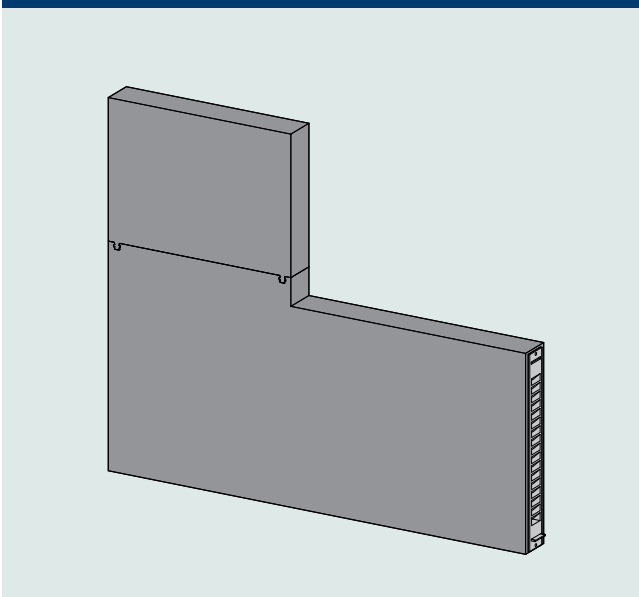

**Vent duct FL**

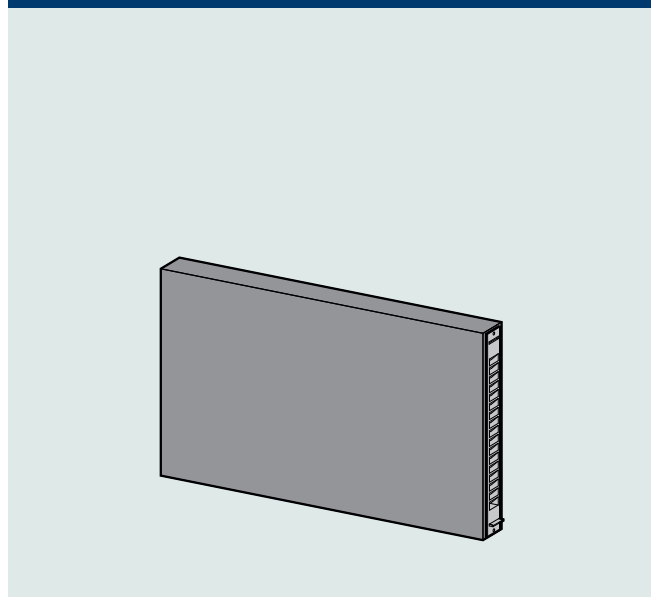

## Vent duct EPP for AEROTUBE wall-mounted ventilator system.

### Installation option vent duct EPP, type FL with AEROTUBE

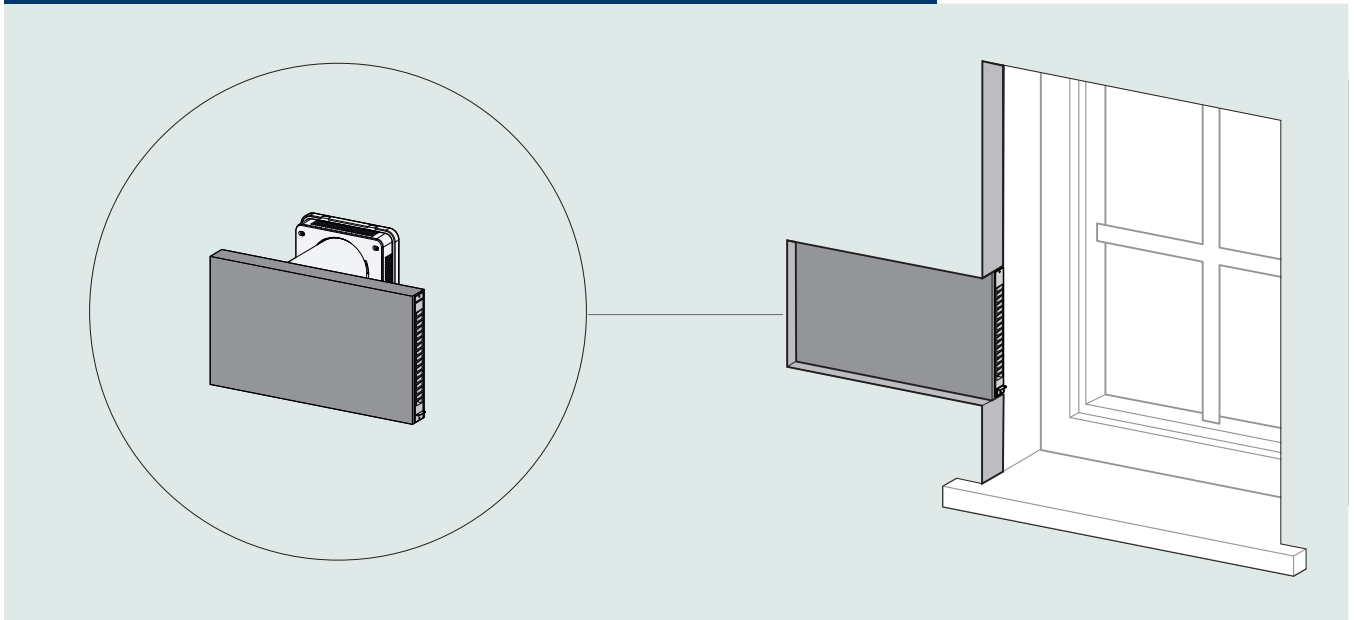

### Installation option vent duct EPP, type SFL with AEROTUBE

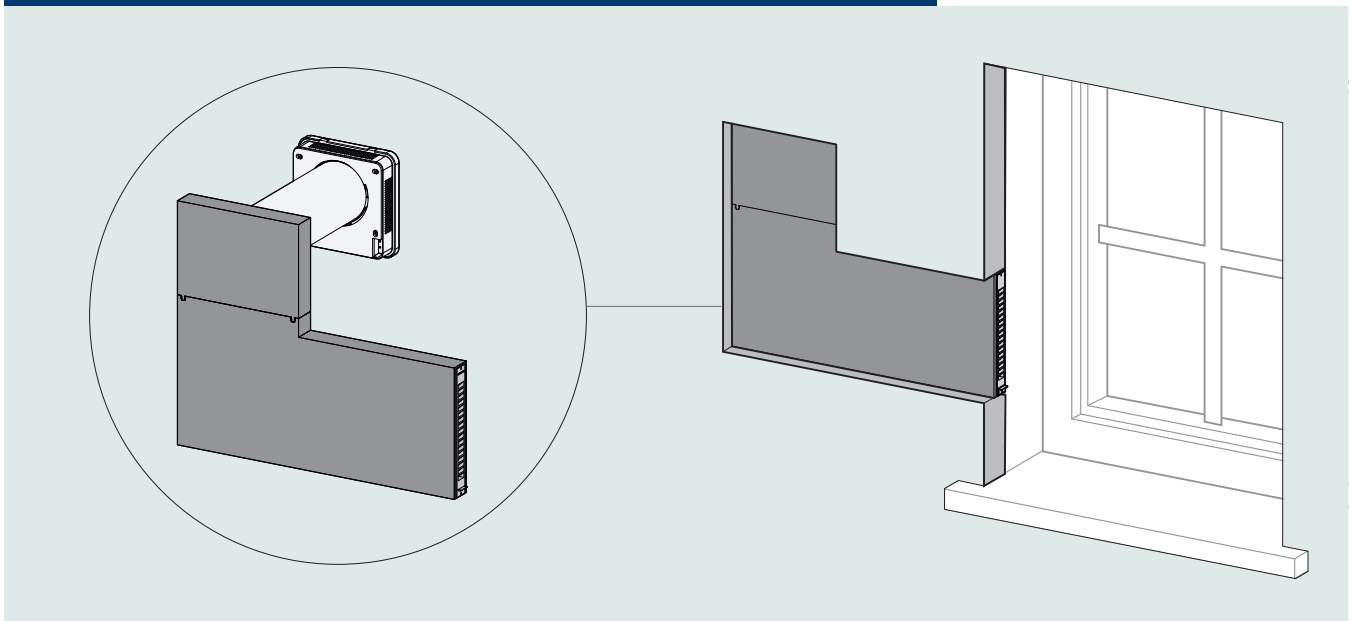

#### Suitable for:

- New builds and renovations
- Single family homes, multi-storey residential buildings and office buildings
- Living rooms and bedrooms

#### Installation options:

- Vent duct EPP, type FL:  
Installation in the window reveal
- Vent duct EPP, type SFL:  
Installation on the side of the window reveal

## Vent duct EPP for AEROPAC wall-mounted ventilator.

### Installation option vent duct EPP, type FL with AEROPAC

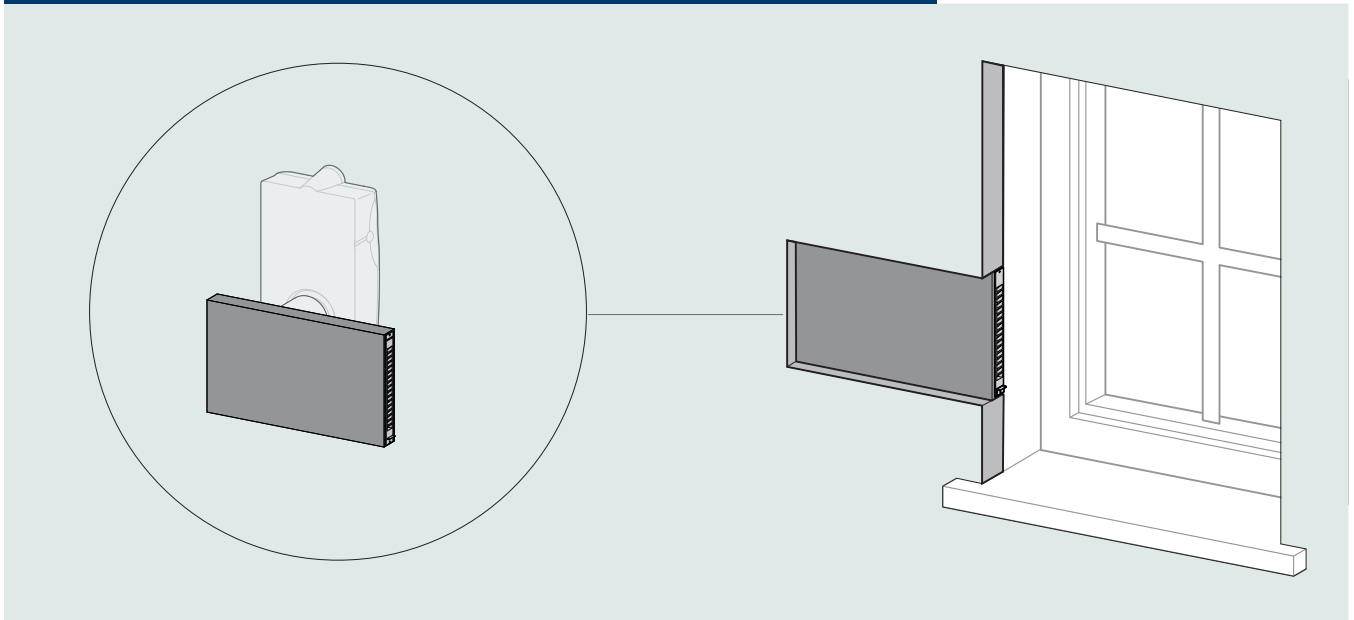

### Installation option vent duct EPP, type SFL with AEROPAC

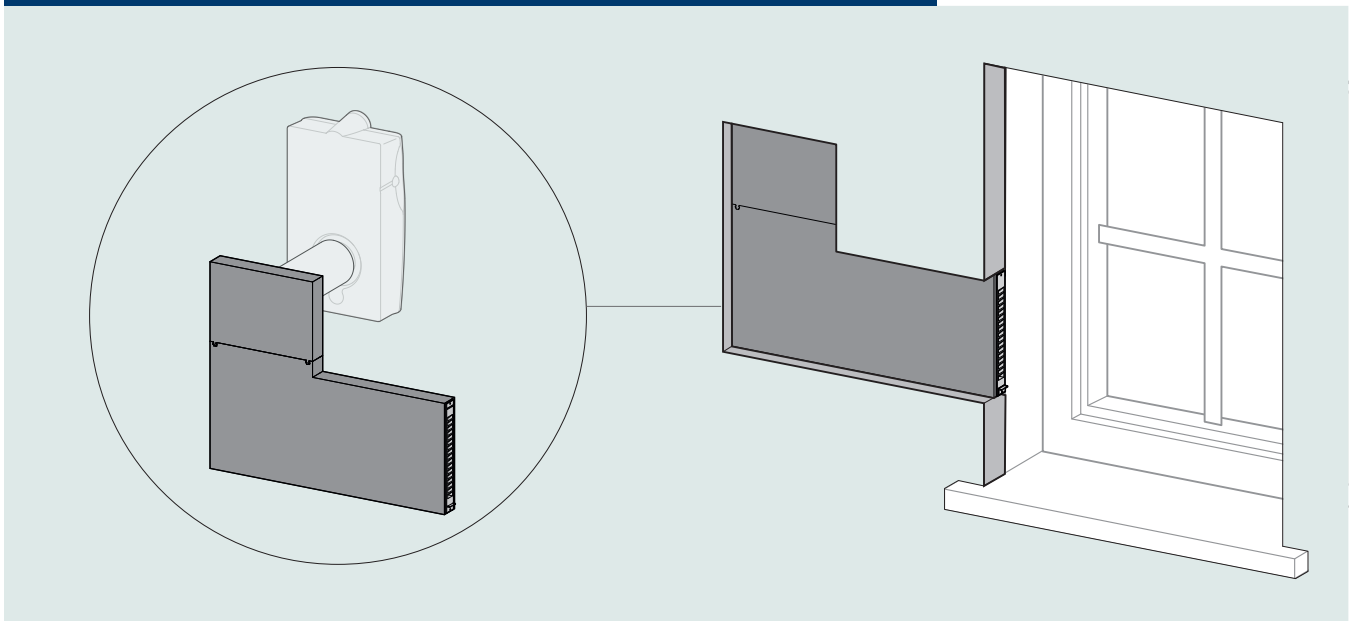

#### Suitable for:

- New builds and renovations
- Single family homes, multi-storey residential buildings and office buildings
- Living rooms and bedrooms

#### Installation options:

- Vent duct EPP, type FL:  
Installation in the window reveal
- Vent duct EPP, type SFL:  
Installation on the side of the window reveal

## Vent duct EPP for AEROVITAL ambience wall-mounted ventilator.

### Installation option vent duct EPP, type FL with AEROVITAL ambience

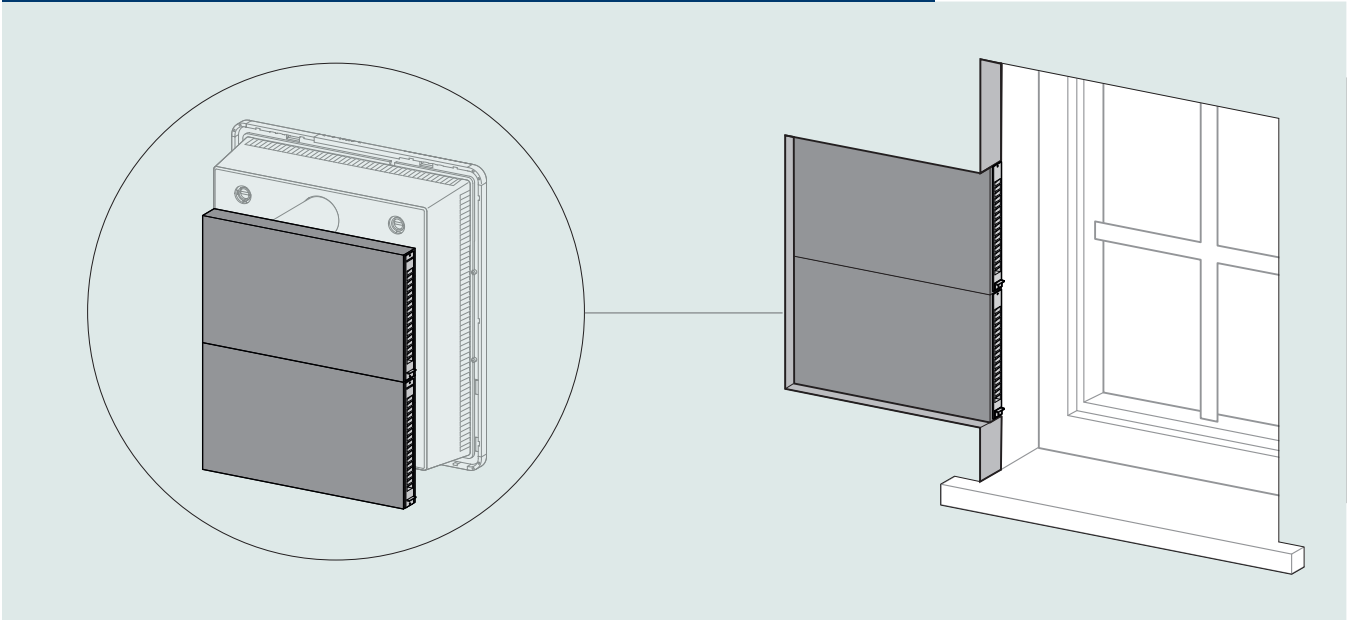

#### Suitable for:

- New builds and renovations
- Single family homes, multi-storey residential buildings and office buildings
- Living rooms and bedrooms

#### Installation options:

- Vent duct EPP, type FL  
Installation in the window reveal

## Detailed view of vent duct EPP type SFL and FL.

### Detailed view of vent duct SFL

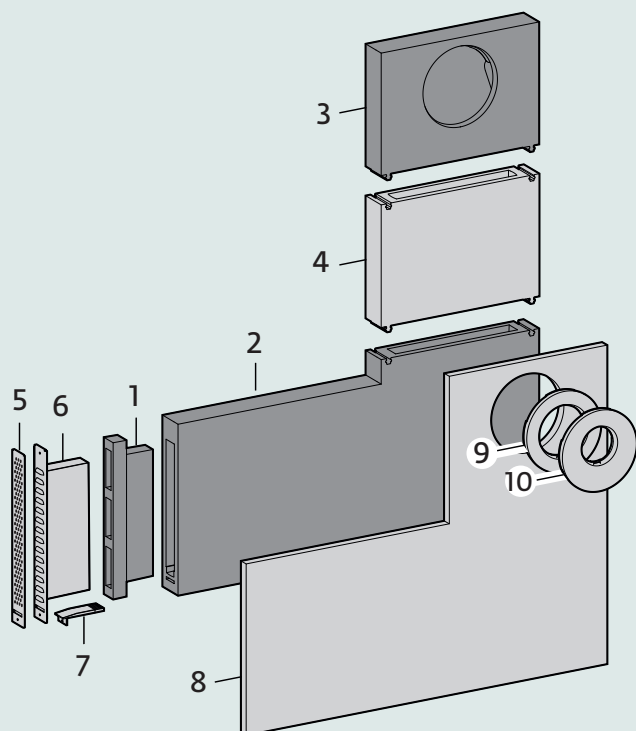

#### Vent duct EPP

- 1 Plaster cover
- 2 Vent duct SFL (corner drive)
- 3 Vent duct SFL transition piece SFL

#### Accessories

- 4 Extension (max. 5 pieces)
- 5 Weather grille, perforated grid (either)
- 6 Weather grille, lamella (either)
- 7 Outlet duct
- 8 Insulation plate SFL (optional)
- 9 Pipe adapter D110 (dependent on product)
- 10 Pipe adapter D80 (dependent on product)

### Detailed view of vent duct FL

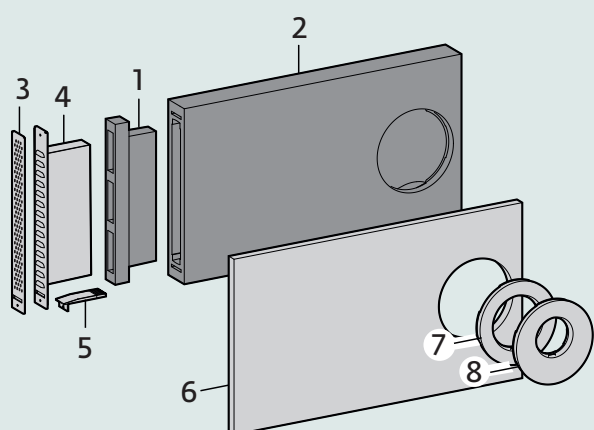

#### Vent duct EPP

- 1 Plaster cover
- 2 Vent duct FL

#### Accessories

- 3 Weather grille, perforated grid (either)
- 4 Weather grille, lamella (either)
- 5 Outlet duct
- 6 Insulation plate FL (optional)
- 7 Pipe adapter D110 (dependent on product)
- 8 Pipe adapter D80 (dependent on product)

# **SIEGENIA®**

brings spaces to life

Head Office:  
Industriestraße 1–3  
57234 Wilnsdorf  
GERMANY

Phone: +49 271 3931-0  
Telefax: +49 271 3931-333  
info@siegenia.com  
www.siegenia.com



You can find address details for our  
international sites at: [www.siegenia.com](http://www.siegenia.com)

## SIEGENIA worldwide:

**Austria** Phone: +43 6225 8301  
**Belarus** Phone: +375 17 2573988  
**Benelux** Phone: +31 85 4861080  
**China** Phone: +86 316 5998198  
**France** Phone: +33 3 89618131  
**Germany** Phone: +49 271 39310  
**Great Britain** Phone: +44 2476 622000  
**Hungary** Phone: +36 76 500810

**India** Phone: +91 124 4342302  
**Italy** Phone: +39 02 9353601  
**Poland** Phone: +48 77 4477700  
**Russia** Phone: +7 495 7211762  
**South Korea** Phone: +82 31 7985590  
**Switzerland** Phone: +41 33 3461010  
**Turkey** Phone: +90 216 5934151  
**Ukraine** Phone: +380 44 4054969

Contact your dealer: